

Proposed First floor

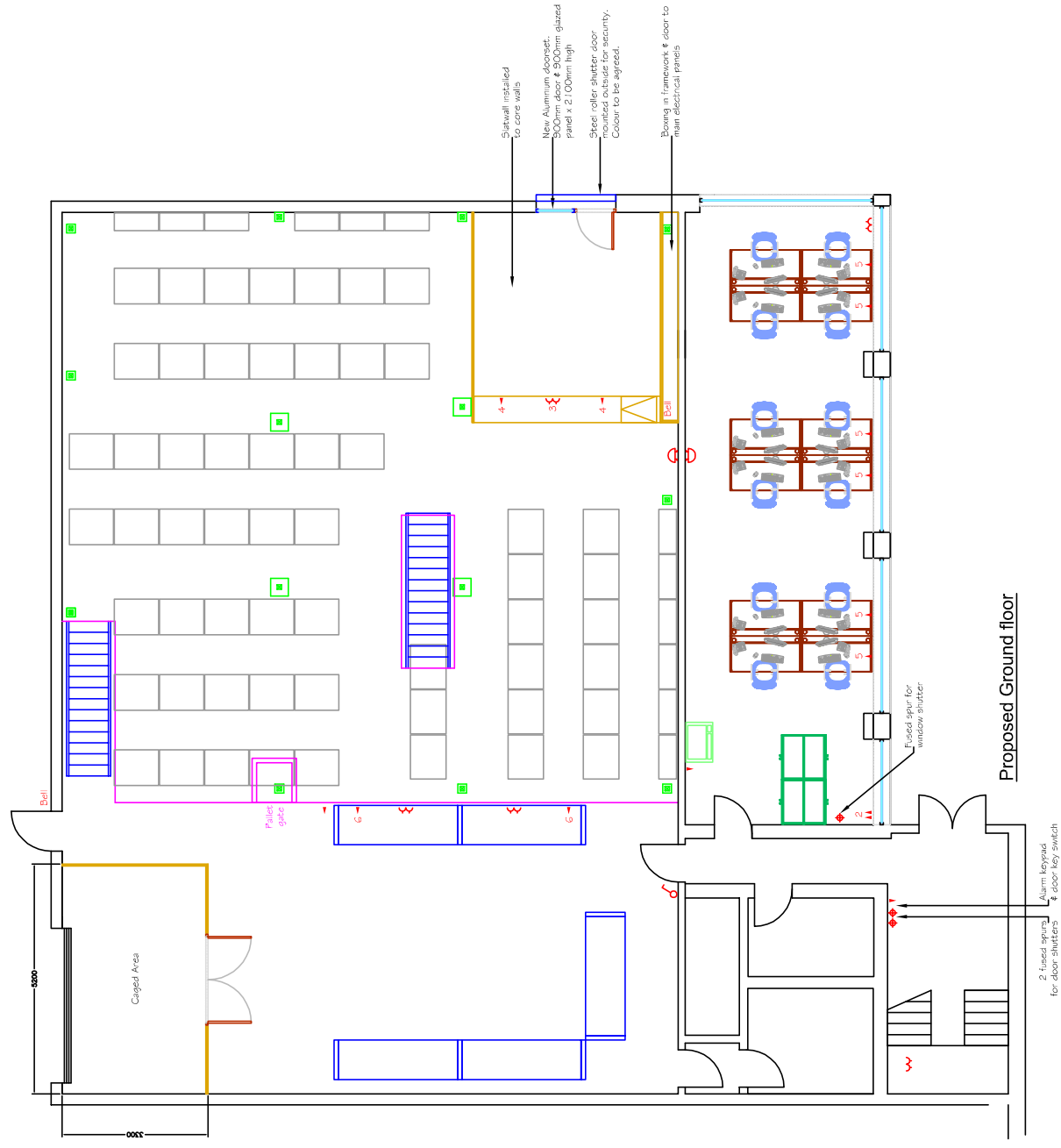

Proposed Ground floor

Other file No.:		
Rev	Date	
C	10.09.14	
B	26.07.14	
A	02.04.14	
-	20.03.14	
Rev	Date	
Dwg No.: CBS 015	Quote No.: Q	Job No.: P
Scale: A3 - 1:150	Drawn by: P. Huntington	
Scale: A1 - 1:75		
CLIENT:		

Power & data added	10.09.14
Mezzanine & partition changes	26.07.14
Furniture changes	02.04.14
New Drawing	20.03.14
Revision Details	Date

Cromwell

DRAWING / PROJECT TITLE:
New Mezzanine & Partition Proposals
 6365 Edinburgh Avenue

CBS COMMERCIAL BUILDING SOLUTIONS.

91, Ashington Lane,
 Wimborne, Dorset.
 BH21 3DG
 07970 291216

bailey.simon@rocketmail.com